



landscape development application

DESIGN REGISTER

DRAWING NUMBER	SHEET NAME			REV. No.	REV. DATE
13281.5	DA	C	L00	C	21/05/2021
13281.5	DA	B	L01	B	19/03/2021
13281.5	DA	C	L02	C	05/05/2021
13281.5	DA	C	L03	C	21/05/2021

Port of Newcastle
Raven St Kooragang Industrial
Lot 152 Raven St, Kooragang, NSW



SITE – GENERAL DESCRIPTION

The following landscape Design Report has been prepared in accordance with the requirements of Newcastle City Council Development Control Plan 2012.

The development site is located in the industrial area in Kooragang. The development site is a vacant, flat parcel of land. Newcastle Coal Infrastructure Group is to the north of the project site, and Port Waratah Coal Operations is to the east of the site.

SOIL TYPE

The site soil is classified as disturbed terrain, according to Newcastle soil landscape series sheet 9232 (Matthei, 1995). Due to extensively disturbed by human activity, the original vegetation is completely cleared and replaced with grassland. The soils are highly variable.

VEGETATION AND LANDSCAPE CHARACTER

There is limited vegetation on site, mainly some grass patches. There is a vegetation buffer between project site and Newcastle Coal Infrastructure Group, which has provided a dense canopy coverage and reduced visual impact of coal facilities. To the front of the project site, along Raven Street, grass and overhead power lines dominate the street side. The surroundings of the project site are very industrial. The coal infrastructure and warehouses have strongly contributed to the characters of the site.

PROPOSED LANDSCAPE WORKS AND OBJECTIVES

The proposed development on the site involves the construction of warehouses, parking bays, offices and carparks (refer to architectural plans). The objectives of the proposed landscape are,

To provide shade to carpark area to achieve 50% shade coverage. According to Newcastle Development Control Plan (NDCP) 2021, to provide one shade tree per six parking spaces, and the selected tree species are to ‘develop a clean trunk height greater than 4.5m and a crown projection of at least 50m2 to provide adequate shade and vehicle clearance’ and ‘shade area is to be calculated from the estimated crown projections of a tree 15 years in age under suitable growing conditions’ (Newcastle City Council, 2012). Our selected carpark tree is *Lophostemon confertus* (Queensland Brush Box). Mature size of the tree is 15 x 10m. Brush Box is fast growing tree with dense foliage cover, and drought resistant.

To provide an understorey to the garden areas to the carpark to maintain clear sightlights.

To provide shrubs and screening planting to eastern site to screen cars from the street.

To provide shrubs and groundcovers along northern and western boundary fence to reduce the visual impact and provide amenity to the site.

To provide contrasting paving to highlight pedestrian zones to increase safety and amenity.

To provide shelters with picnic settings near staff amenities for outdoor recreation.

REFERENCES

Newcastle City Council, 2012, *Newcastle Development Control Plan*.
Matthei, L.E, 1995, *Soil Landscapes of Newcastle 1:100 000 Sheet Report*, Department of Land & Water Conservation, Sydney.



Site Anaylsis Plan (base plan: nearmap, 28.11.2020)

Legend

- Property line
- Existing fence
- Overhead power line
- Existing vegetation
- View point

B	19/03/2021	FOR DA
A	12/03/2021	FOR COORDINATION
REV	DATE	COMMENTS

SITE:
LOT 152 RAVEN ST,
KOORAGANG

CLIENT:
PORT OF NEWCASTLE

DRAWN: YY/PMW DATE: 19/03/2021 SCALE:

JOB NUMBER: 13281.5 PHASE: DA DWG No: L01 REV: B

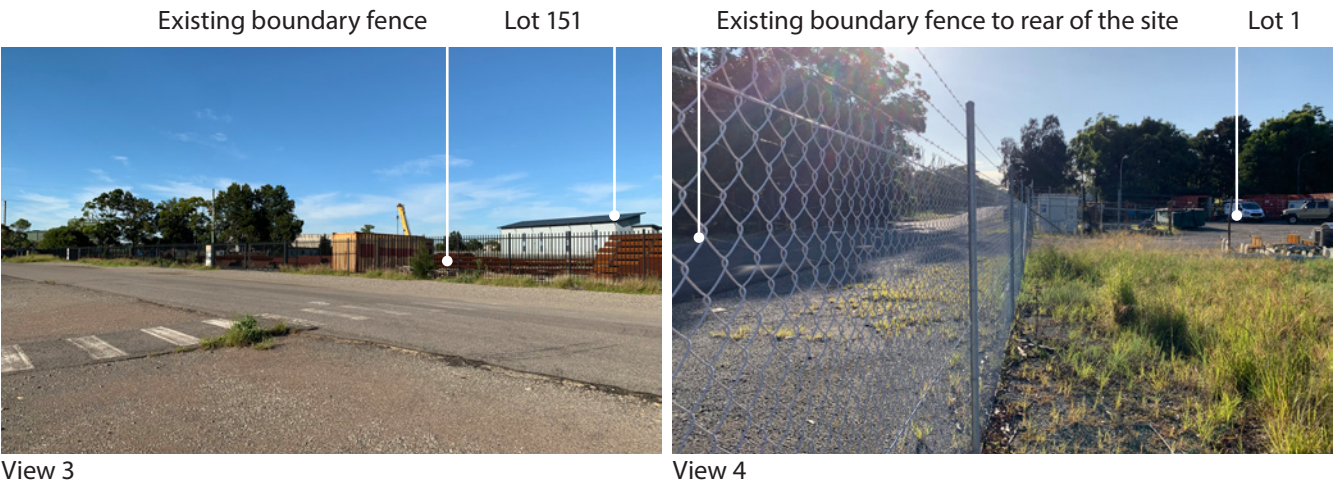
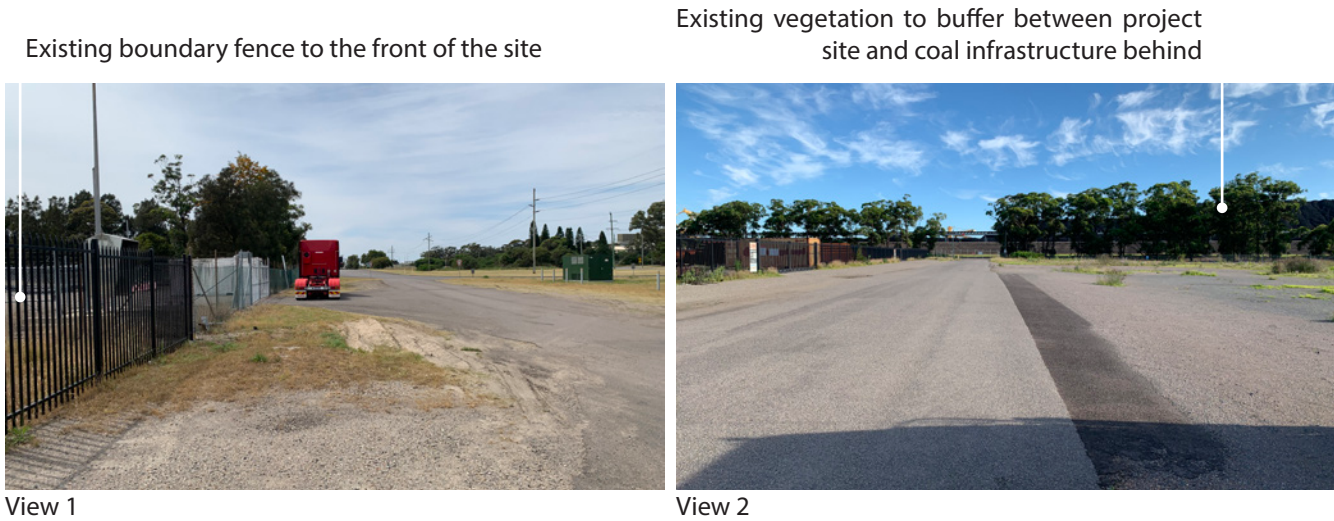

Raven St Kooragang Industrial

L02

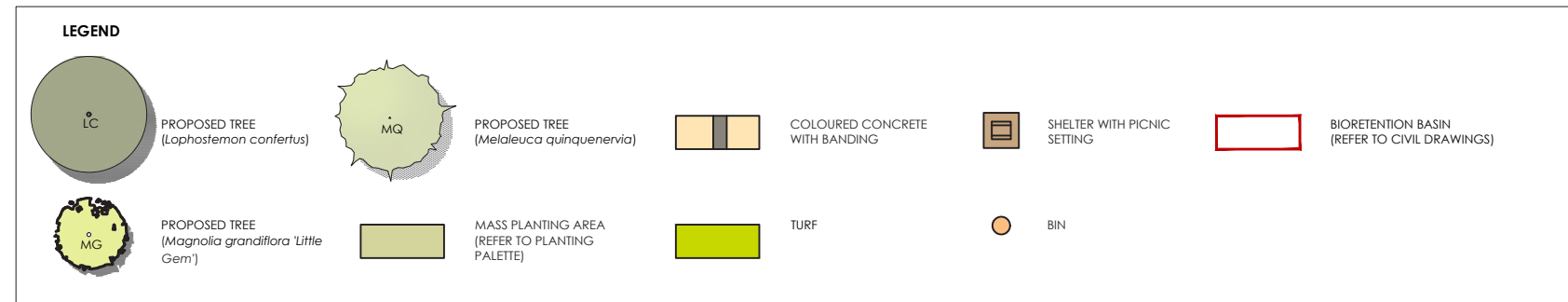

C	05/05/2021	FOR DA
B	19/03/2021	FOR DA
A	12/03/2021	FOR COORDINATION
REV	DATE	COMMENTS

DRAWN: YY/PMW DATE: 05/05/2021 SCALE: 1:200@A3

JOB NUMBER: 13281.5 PHASE: DA L02 DWG No: C REV:



plant schedule

BOTANICAL NAME	COMMON NAME	POT SIZE	MATURE HEIGHT x WIDTH
Trees			
<i>Lophostemon confertus</i>	Queensland Brush Box	75L	15m x 10m
<i>Magnolia grandiflora</i> 'Little Gem'	Southern Magnolia	75L	6m x 3m
<i>Melaleuca quinquenervia</i>	Paperbark	75L	8-10m x 5-6m
Shrubs & Groundcovers			
<i>Callistemon viminalis</i> 'Little John'	Bottle Brush	140mm	0.7-1m x 0.5-1m
<i>Carpobrotus glaucescens</i>	Pigfaces	140mm	0.1-0.3m x 2m
<i>Dietes grandiflora</i>	Wild Iris	140mm	1m x 1m
<i>Doryanthes excelsa</i>	Gymea Lilly	140mm	1.5-4m x 2m
<i>Dianella caerulea</i> 'Little Jess'	Native Flax	140mm	0.4 x 0.4m
<i>Grevillea lanigera</i> 'Mount Tamboritha'	Mount Tamboritha Grevillea	140mm	0.4m x 1-2m
<i>Raphiolepis indica</i> 'Snow Maiden'	Snow Maiden Indian Hawthorn	140mm	0.75-1m x 0.5m
<i>Syzygium</i> 'Cascade'	Lilly Pilly	140mm	2-3m x 1-2m
<i>Westringia fruticosa</i> 'Mundi'	Mundi Westringia	140mm	0.5m x 1.5m
<i>Zamia furfuracea</i>	Cardboard Plant	140mm	1.2m x 2m
<i>Lomandra longifolia</i> 'Tanika'	Mat Rush	140mm	0.5-0.65m x 0.65
<i>Trachelospermum jasminoides</i>	Star jasmine	140mm	0.5m x 2m

trees



Lophostemon confertus

shrubs & groundcovers



Zamia furfuracea



Dianella caerulea 'Little Jess'



Grevillea lanigera 'Mount Tamboritha'



Callistemon viminalis 'Little John'



Westringia fruticosa 'Mundi'



Lomandra longifolia 'Tanika'



Syzygium 'Cascade'



Trachelospermum jasminoides

C	21/05/2021	FOR DA
B	19/03/2021	FOR DA
A	12/03/2021	FOR COORDINATION
REV	DATE	COMMENTS

SITE:		
LOT 152 RAVEN ST, KOORAGANG		
CLIENT:		
PORT OF NEWCASTLE		

DRAWN:	DATE:	SCALE:
YY/PMW	21/05/2021	
JOB NUMBER:	PHASE:	DWG No: REV:
13281.5	DA	L03 C